

CREST RIDGE BUSINESS PARK

Located at the southeast corner of Durango Road and Oquendo Road



SPECIFICATIONS

LOCATION

The property is accessible from both Durango Drive and Oquendo Road which is 600' south of Russell Road. The site is easily accessible from both the Durango Drive and I-215 as well as the Russell Road and I-215 interchanges.

MUNICIPALITY

Clark County

ZONING

C-1 and C-2

PARCEL NUMBER

163-33-212-001

ACREAGE

5 acres

AREA DEVELOPMENTS

- Located in the rapidly expanding southwest sub-market
- Upon build-out an estimated 50,000+ people will live in surrounding neighborhoods
- Stations Casinos developing neighborhood hotel and casino at Durango Drive and I-215
- Major hospital facilities in immediate area: St. Rose Hospital, Southern Hills Hospital, Spring Valley Hospital

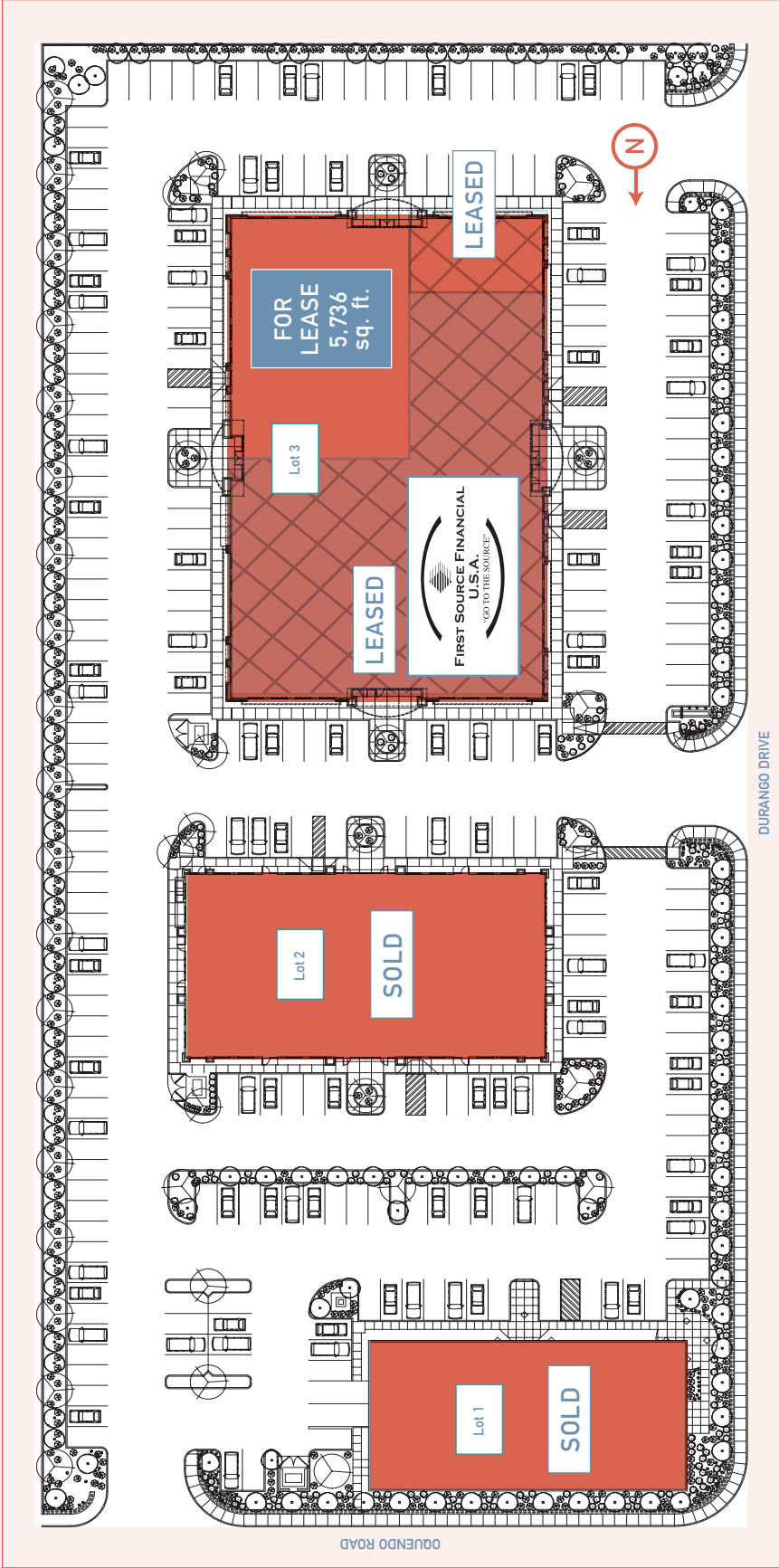

SITE MAP

DEMOGRAPHICS

| Category | 1 Mile | 3 Mile | 5 Mile |
|-----------------------|----------|----------|----------|
| Households | 2,331 | 27,491 | 75,383 |
| Population | 6,993 | 70,607 | 185,158 |
| Avg. Household Income | \$68,630 | \$80,550 | \$66,300 |

PRICING

Lot 3 - FOR LEASE - 5,736 sq. ft. - \$2.10 per sq. ft. Modified Gross

CREST RIDGE BUSINESS PARK

AERIAL MAP



CREST RIDGE BUSINESS PARK

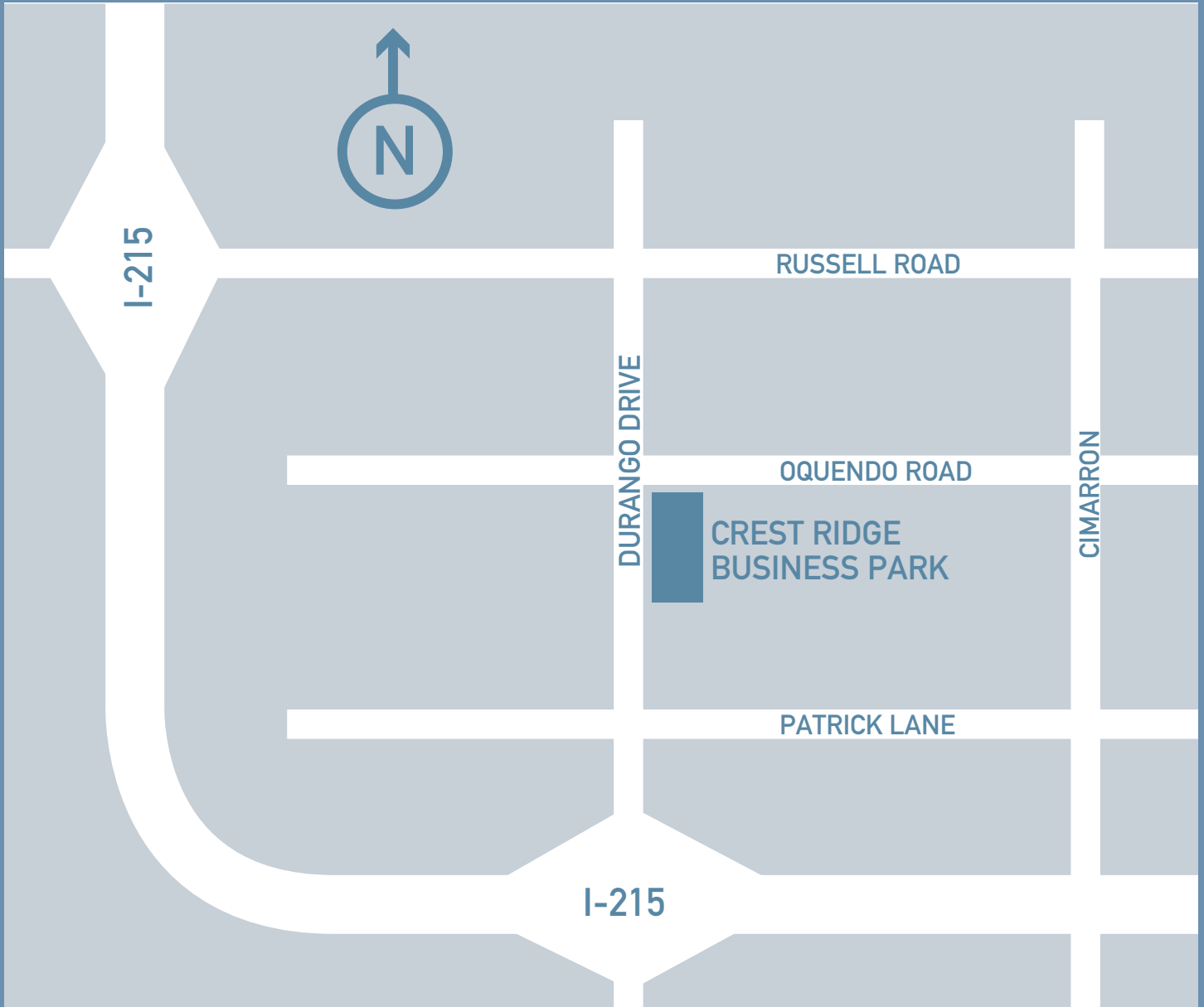

FOR INFORMATION CONTACT



Todd Nigro
Owner/Licensee
Randi Shanel
Corporate Sales
and Leasing

Nigro Development
3965 South Durango Drive, Suite 106
Las Vegas, Nevada 89147

phone 702.247.1915
fax 702.247.1916
email rshanel@nigrodevelopment.net
web www.nigrodevelopment.net

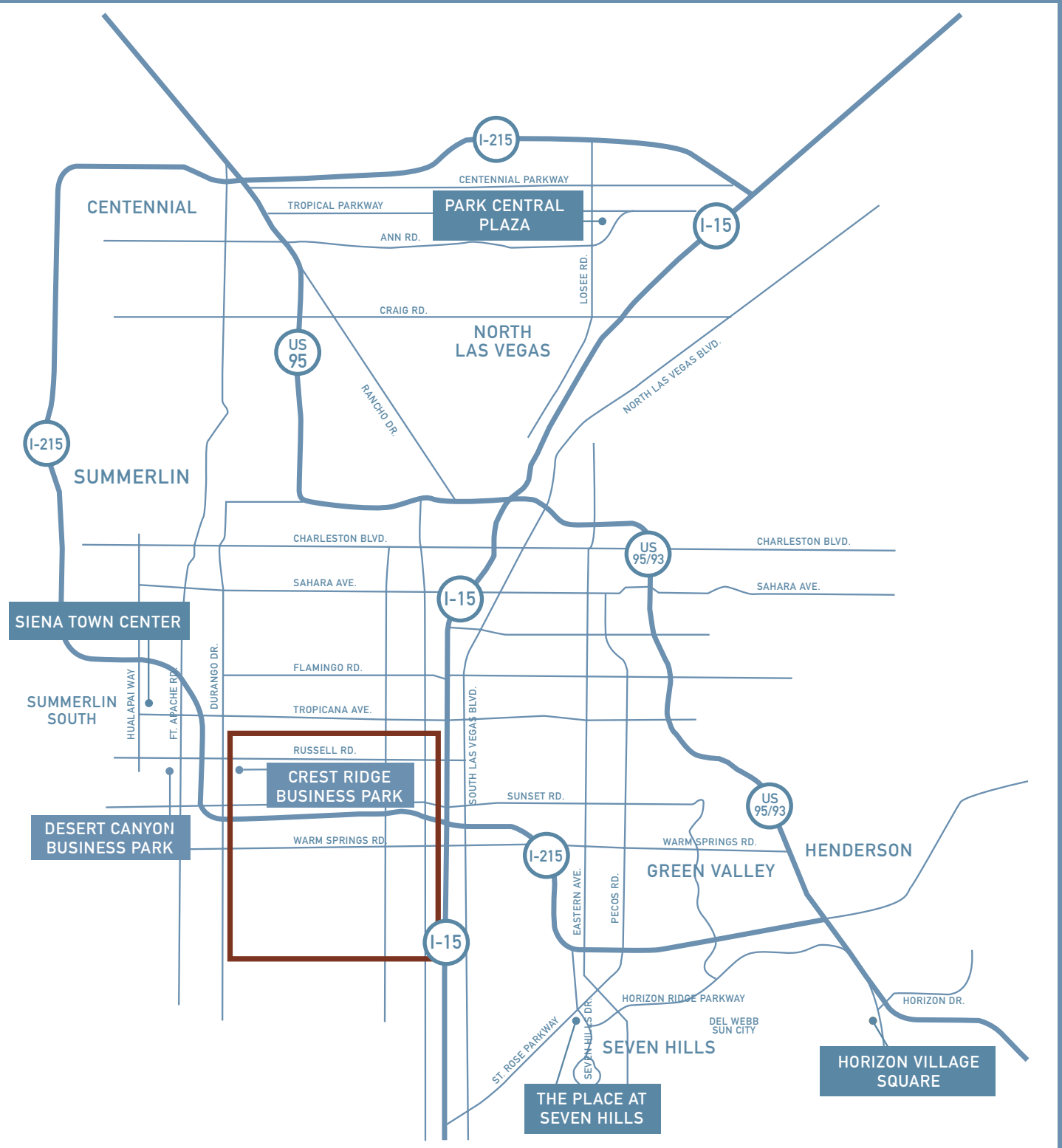

FOR INFORMATION CONTACT



Todd Nigro
 Owner/Licensee

Randi Shanel
 Corporate Sales
 and Leasing

Nigro Development
 3965 South Durango Drive, Suite 106
 Las Vegas, Nevada 89147

phone 702.247.1915
 fax 702.247.1916
 email rshanel@nigrodevelopment.net
 web www.nigrodevelopment.net