

Desert Canyon

BUSINESS PARK

Located at the I-215 "Beltway" and Russell Road



SPECIFICATIONS

LOCATION

I-215 "Beltway" and Russell Road

MUNICIPALITY

Clark County

ZONING

C-2

PARCEL NUMBER

163-32-111-001

ACREAGE

15 acres

PROJECT

Master Planned Business Park

HIGHLIGHTS

- Prime medical address adjacent to Southern Hills Hospital
- Freeway visibility and signage for your business
- Sophisticated and unique desert architecture and landscaping designs
- Building signage available for large tenants
- 1st and 2nd generation space available



702-247-1915

SITE MAP

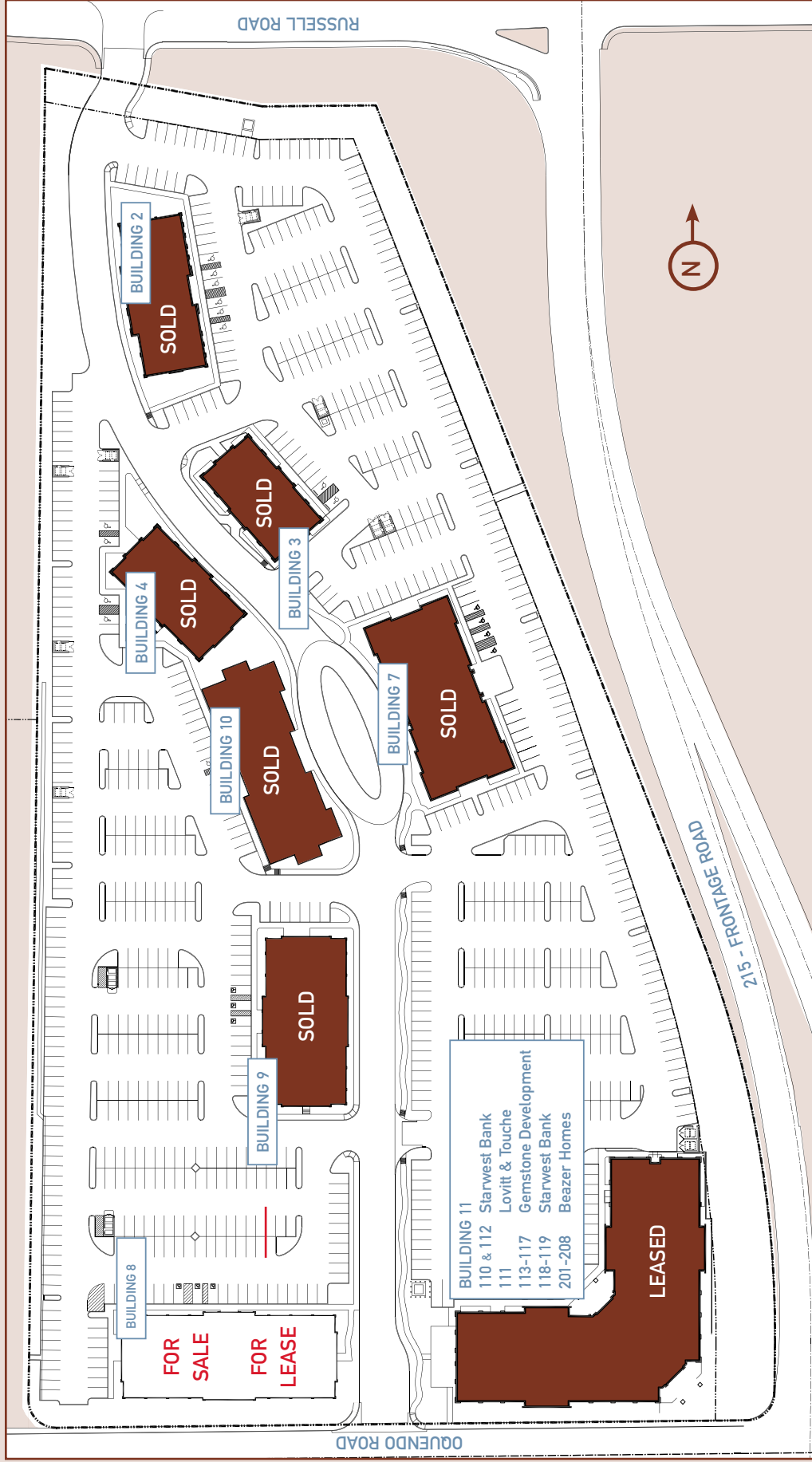

Desert Canyon

BUSINESS PARK



702-247-1915

Desert Canyon

BUSINESS PARK

AERIAL VIEW



702-247-1915

Desert Canyon

BUSINESS PARK

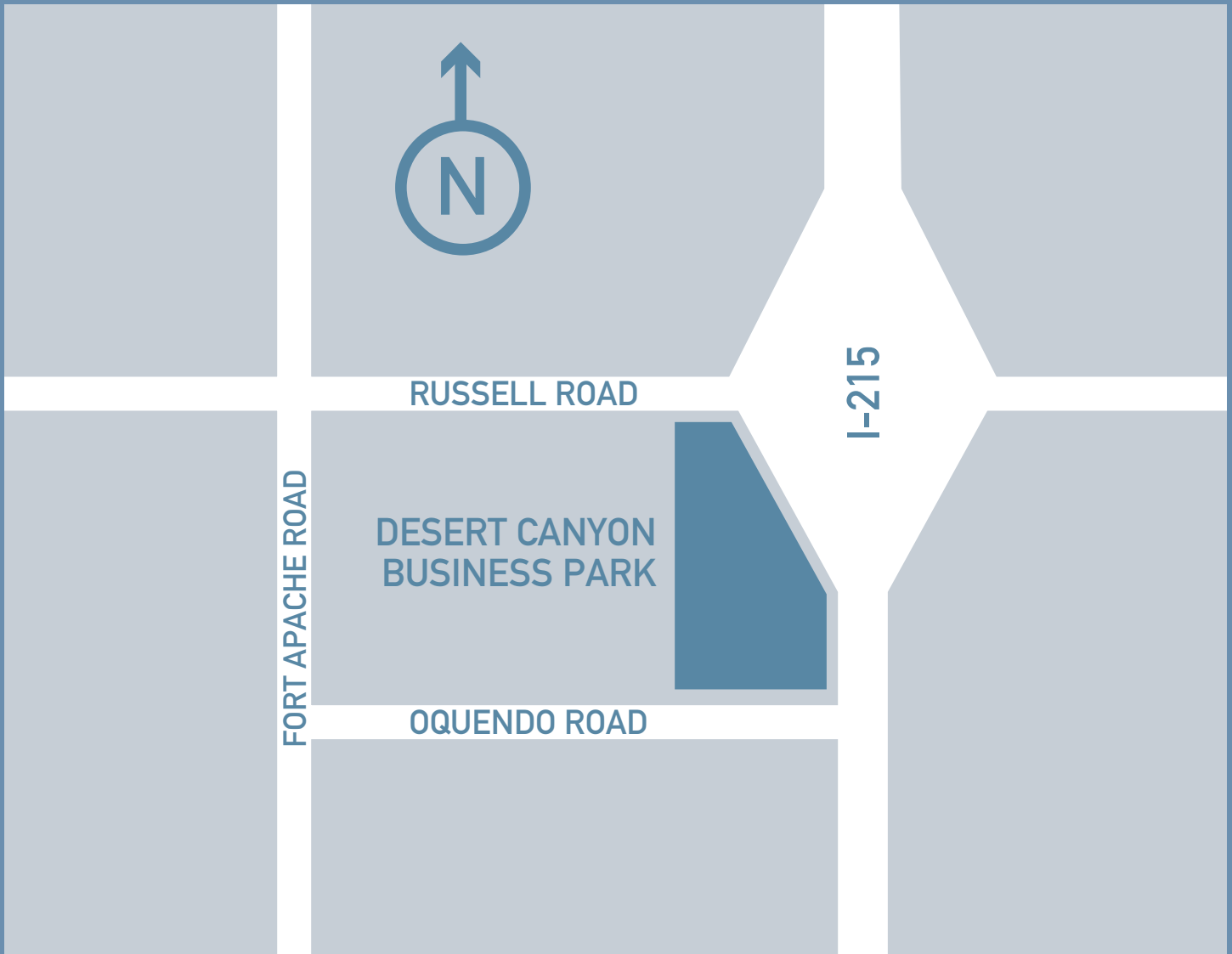

FOR INFORMATION CONTACT

Todd Nigro
Owner/Licensee
Jennifer Ott
Leasing Director

Nigro Development
9115 W. Russell Road, Suite 210
Las Vegas, Nevada 89148

phone 702.247.1915
fax 702.247.1916
email jennifer@nigrodevelopment.net
web www.nigrodevelopment.net



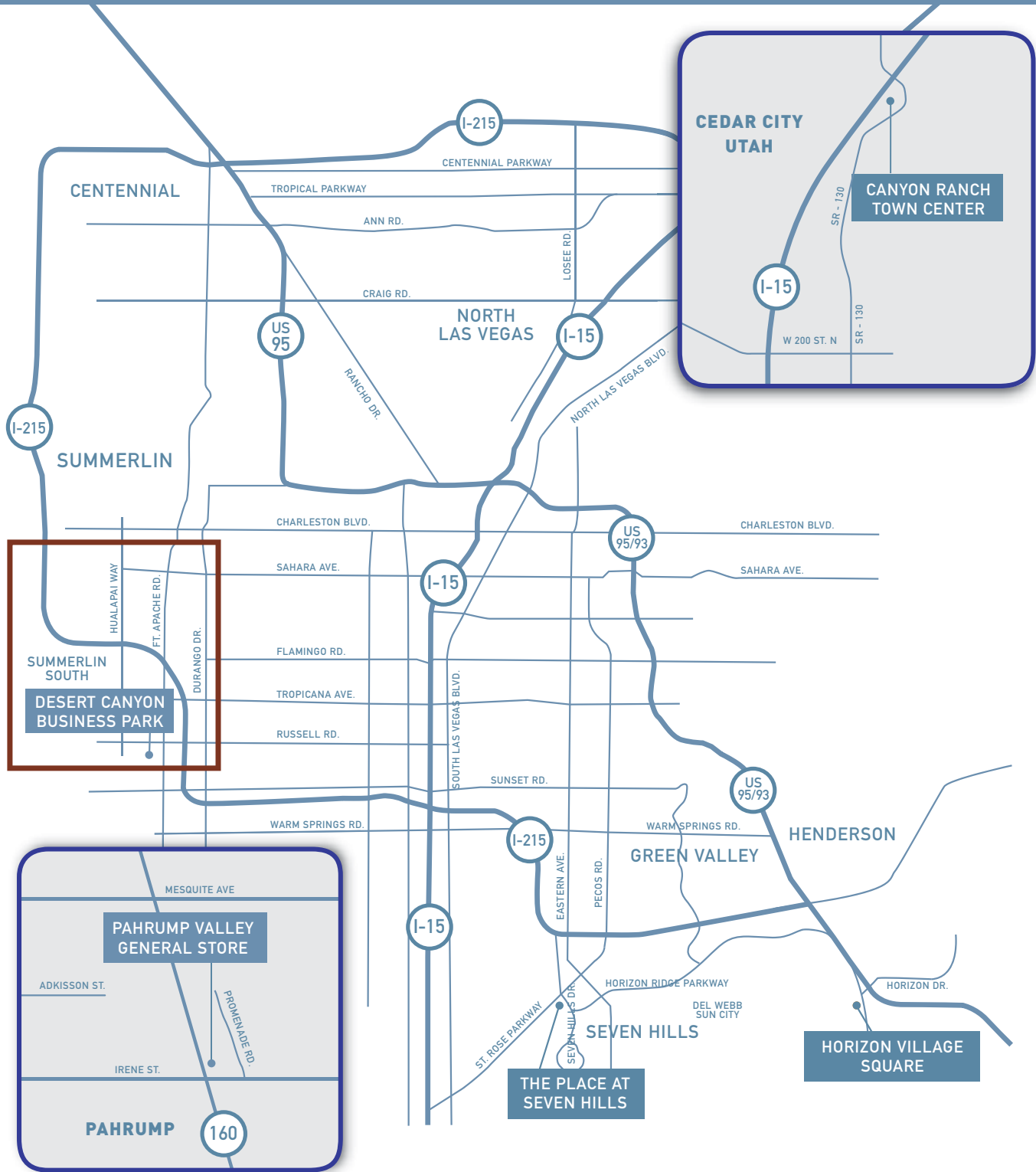

FOR INFORMATION CONTACT



Todd Nigro
 Owner/Licensee
 Jennifer Ott
 Leasing Director

Nigro Development
 9115 W. Russell Road, Suite 210
 Las Vegas, Nevada 89148

phone 702.247.1915
 fax 702.247.1916
 email jennifero@nigrodevelopment.net
 web www.nigrodevelopment.net